

## Sofia 10W CCT (White) Datasheet

830-910Lm LED Track Spotlight

PXSOF10WCCT

Single  
Circuit

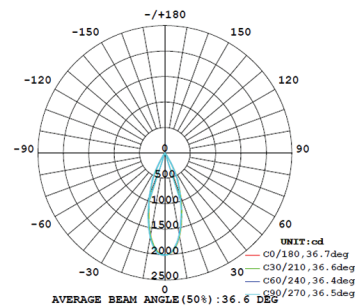
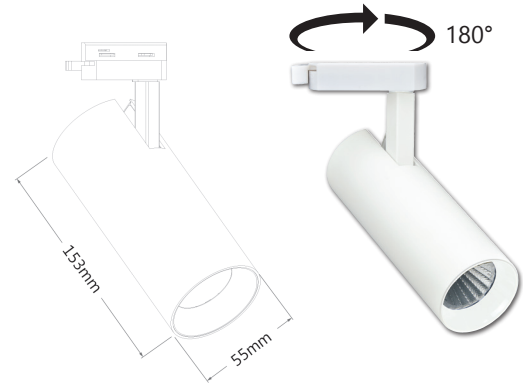

10W

IP20

LED

240V

<b>Dimensions</b>	ø55*153mm
<b>Cutout</b>	N/A
<b>Weight</b>	0.38Kg
<b>Material</b>	Aluminium & PC
<b>Colour/Finish</b>	White
<b>IK Rating</b>	IK06
<b>Voltage/Frequency</b>	AC 220-240V, 50-60Hz
<b>Luminous Flux</b>	830-910Lm
<b>Luminous Efficacy</b>	83-91Lm/W
<b>Color Rendering Index</b>	≥90
<b>CCT Colour Temp</b>	2700K / 4000K / 6000K
<b>SDCM Colour Consistency</b>	≤6
<b>UGR Unified Glare Rating</b>	≤19
<b>LEDs</b>	COB
<b>Light Control</b>	Triac Dim
<b>Beam Angle</b>	36°
<b>Adjustable</b>	180° (H)
<b>Chip</b>	Tianxin
<b>Maintained Luminous Flux</b>	L80 (B10) 35,000h
<b>Warranty</b>	3 Years

## Features & Applications

The COB LEDs in the Sofia 10W provide excellent colour rendering and an even light output, making it an ideal choice of fitting for commercial applications such as retail and department stores, galleries and museums.

The adjustable lighting orientation also makes the Sofia an extremely flexible option. The 10W model comes with a 3 year warranty.