

NICO 12W LED Spotlight (White)

4000K 1020lm



Product Code: PX12WH4K



Technical Specifications

Model	Voltage	Power	Power Factor	Lumen (±5%)	Beam Angle	CCT	Lifespan	CRI	Dimensions
12W	AC100-240V	12W	≥0.9	1020	15° 30°	4000K	40000h	≥80	L126.5*W89*H220mm

Driver Data Sheet

Driver Data	Non-dim
Input Rated Voltage	AC100-240V
Frequency	50/60Hz
Input Voltage	AC85-265V
Efficiency	≥83%
Total Load Wattage	12W±1W
Power Factor	≥0.9
Rated Input Current	≤0.15A
Full Load Output Voltage	DC30-40V
Rated Output Current	280mA
Output Current Range	280mA±5%
Power Tolerance	±5%
Current Output Tolerance	±5%
Dimming Range	-
Dimmer	-
Short Circuit Protection	PASS
Over Voltage Protection	PASS
Over Temperature Protection	PASS
Withstand Voltage	AC1500V

Fixture Compatibility

Rated Wattage	12W
Electrical Classification	I
Ingress Protection	IP20
Operating Temperature	-20°C~45°C
Operating Humidity	0~90%
Storage Temperature	-20°C~65°C

Beam Angle

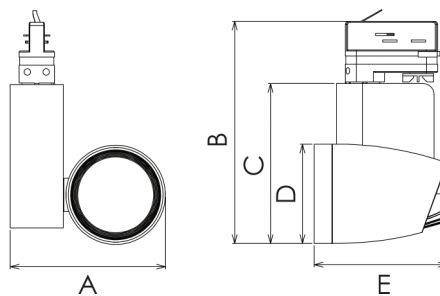
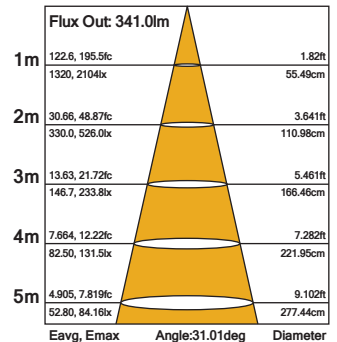

12W Dimensions (mm)

A	126.5
B	194
C	137.5
D	ø75
E	104

Prelux Nico track lights adopt COB LEDs with excellent color rendering index to increase the color fidelity of the target illuminated object. It provides excellent heat dissipation and even light output without glare or dark spot. Adjustable lighting orientation with 360 degree in horizontal direction and 180 in vertical direction provided. 1-circuit adapter, 2-circuit adapter, 3-circuit adapter are all available.

- Environment friendly, without Mercury or other hazardous substances
- Up to 70% energy saving compared to standard CFL
- Adjustable 360° degrees horizontally, 180° degrees vertically
- Long lifetime of 40,000 hours
- 15° 30° beam angle
- CCT: 4000K
- No UV/IR light