

# NICO 35W LED Spotlight (Black)

4000K 3000lm



**PRELUX**  
LED PRODUCTS

Product Code: PX35BL4K



## Technical Specifications

| Model | Voltage    | Power | Power Factor | Lumen (±5%) | Beam Angle  | CCT   | Lifespan | CRI | Dimensions       |
|-------|------------|-------|--------------|-------------|-------------|-------|----------|-----|------------------|
| 35W   | AC100-240V | 35W   | ≥0.9         | 3000        | 15°/24°/45° | 4000K | 40000h   | ≥80 | L161*W131*H234mm |

## Driver Data Sheet

| Driver Data                 | Non-dim    |
|-----------------------------|------------|
| Input Rated Voltage         | AC100-240V |
| Frequency                   | 50/60Hz    |
| Input Voltage               | AC85-265V  |
| Efficiency                  | ≥86%       |
| Total Load Wattage          | 35W±1W     |
| Power Factor                | ≥0.9       |
| Rated Input Current         | ≤0.46A     |
| Full Load Output Voltage    | DC23-39V   |
| Rated Output Current        | 820mA      |
| Output Current Range        | 820mA±5%   |
| Power Tolerance             | ±5%        |
| Current Output Tolerance    | ±5%        |
| Dimming Range               | -          |
| Dimmer                      | -          |
| Short Circuit Protection    | PASS       |
| Over Voltage Protection     | PASS       |
| Over Temperature Protection | PASS       |
| Withstand Voltage           | AC3750V    |

## Fixture Compatibility

|                           |            |
|---------------------------|------------|
| Rated Wattage             | 35W        |
| Electrical Classification | II         |
| Ingress Protection        | IP20       |
| Operating Temperature     | -20°C~45°C |
| Operating Humidity        | 0~90%      |
| Storage Temperature       | -20°C~65°C |

## Beam Angle

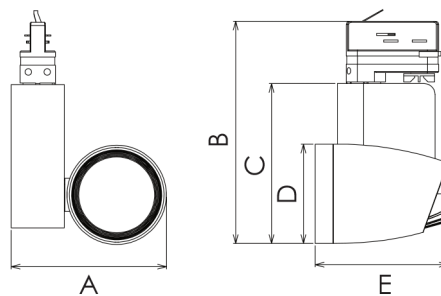
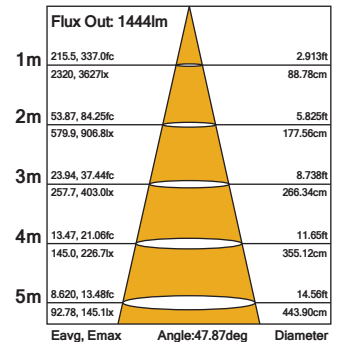

## 35W Dimensions (mm)

|   |      |
|---|------|
| A | 161  |
| B | 234  |
| C | 167  |
| D | ∅110 |
| E | 131  |

Prelux Nico track lights adopt COB LEDs with excellent color rendering index to increase the color fidelity of the target illuminated object. It provides excellent heat dissipation and even light output without glare or dark spot. Adjustable lighting orientation with 360 degree in horizontal direction and 180 in vertical direction provided. 1-circuit adapter, 2-circuit adapter, 3-circuit adapter are all available.

- Environment friendly, without Mercury or other hazardous substances
- Up to 70% energy saving compared to standard CFL
- Adjustable 360° degrees horizontally, 180° degrees vertically
- Long lifetime of 40,000 hours
- 15°/24°/45° beam angle
- CCT: 4000K
- No UV/IR light